

# CUSTOM LIGHTING LTD.

M A N U F A C T U R I N G • D E S I G N • T E C H N O L O G Y

## LS-T5HO-HB (8')

### T5HO High-Bay Fixture

Ideal for high-bay applications, the LS-T5HO-HB (8') is engineered to utilize six or eight 54w T5HO lamps and a high-reflectance Miro IV specular reflector. It is designed as an energy-efficient replacement for Metal-Halide luminaires.

Housing constructed from 18 gauge post-painted white steel. Slide-in clear Lexan polycarbonate lenses protect the lamps and reflector. Quick access plates permit ease of installation.



LS-T5HO-HB (8')

LS-502

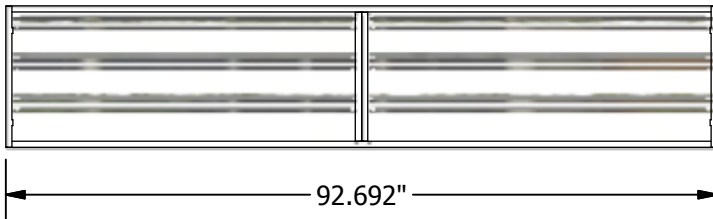

BOTTOM VIEW

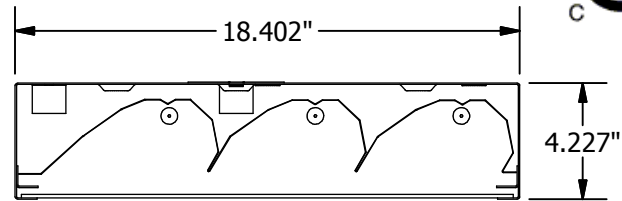

END VIEW

#### Ordering Logic (Choose from available options)

MODEL	FINISH	REFLECTOR MATERIAL	NO. LAMPS / FIXTURE	BALLAST TYPE	LENS STYLE	MOUNTING	VOLTAGE	REFLECTOR STYLE
LS-T5HO-HB	<input type="checkbox"/> PS - POWDER SMOOTH	<input checked="" type="checkbox"/> M - MIRO IV	<input type="checkbox"/> 243 - 3 LAMPS (2'x4') <input type="checkbox"/> 244 - 4 LAMPS (2'x4') <input type="checkbox"/> 286 - 6 LAMPS (2'x8') <input type="checkbox"/> 288 - 8 LAMPS (2'x8')	<input type="checkbox"/> OI-2x2 - Electronic 2-Lamp (x2) <input type="checkbox"/> OI-3x2 - Electronic 2-Lamp (x3) <input type="checkbox"/> OI-4x2 - Electronic 2-Lamp (x4)	<input type="checkbox"/> LX - CLEAR LEXAN <input type="checkbox"/> AC - CLEAR ACRYLIC <input type="checkbox"/> K2 - K12 ACRYLIC	<input type="checkbox"/> 1 - SURFACE <input type="checkbox"/> 2 - PENDANT	<input type="checkbox"/> 1 - 120 VOLT <input type="checkbox"/> 2 - 277 VOLT <input type="checkbox"/> 3 - 347 VOLT	<input type="checkbox"/> ASYM - Asymmetrical <input type="checkbox"/> BW - Batwing



**Custom Lighting Ltd.** 7923 Coronet Road, Edmonton, AB, T6E 4N7  
 Tel: (780) 463-8014 Fax: (780) 463-2216 Email: sales@customlightingltd.com [www.customlightingltd.com](http://www.customlightingltd.com)